

General Product Information:

ROXUL[®] products are mineral wool fibre insulations made from basalt rock and slag. This combination results in a non-combustible product with a melting point of approximately 2150°F (1177°C), which gives it excellent fire resistance properties. ROXUL mineral wool is a water repellent yet vapour permeable material.

Description & Common Applications:

ROXUL Flexibatt[®] R13.5 & R21.5 are mineral wool insulation products for use in both new residential construction and renovations. This semi-rigid batt has a unique flexible edge designed to compress as the batt is inserted into walls, attics, ceiling and floor frames. The flexible edge springs back, expanding the batt against the frame studs to give a complete fill. Flexibatt compensates for normal variations in stud centres caused by distortion or warping. The special flexible characteristic at the insulation edge ensures the expected R-value is achieved.

Compliance and Performance:

CAN/ULC-S702-97	Mineral Fibre Thermal Insulation for Buildings	Type 1, Complies
CAN4-S114	Determination of Non-Combustibility	Non-Combustible
CAN/ULC S102	Surface Burning Characteristics	Flame Spread = 0
		Smoke Developed = 0
NBC 1995, Article 9.25.2.2	Insulation Materials	Conforms
CCMC Evaluation Listing	MasterFormat 07212: Mineral Fibre Batt Insulation	12018-L

Installation:

The flexible edge is identified by the marking.

INSERT

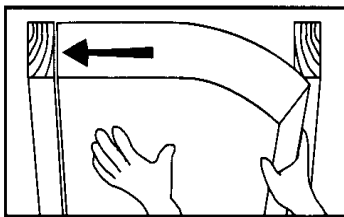

Place Flexibatt into opening, flexible edge against stud

FIT

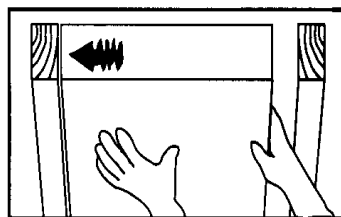

Compress Flexibatt edge and fit batt

RELEASE

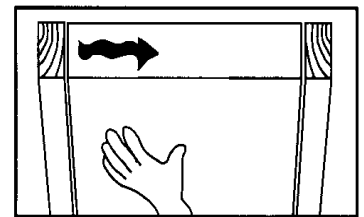

Let Flexibatt expand to give a full fit

The friction fit created by the Flexibatt expansion principle means the product will perform equally well in horizontal, sloped dormer, vertical or overhead situations. The product is notable for its “stay put” ability when installed. Flexibatt is easier and faster to install than traditional insulation products and achieves full R-value.

Tests carried out in 1993 by the National Research Council Of Canada (NRC) confirm that accurate fitting of insulation is essential to achieve R-values and to maintain thermal design requirements in practice. ROXUL Flexibatt has been designed with a flexible edge to ensure the best fit possible.

Flexibatt®

Dimensions:

R13.5 (RSI 2.4)

15.25" x 47" x 3.5"
(387 mm x 1194 mm x 89 mm)

23" x 47" x 3.5"
(584 mm x 1194 mm x 89 mm)

R21.5 (RSI 3.8)

15.25" x 47" x 5.5"
(387 mm x 1194 mm x 140 mm)

23" x 47" x 5.5"
(584 mm x 1194 mm x 140 mm)

This product has been specifically designed to meet your needs for wood stud construction.

Density:

2lbs/ft³ 32kgs/m³

150mm = 4.8kgs/m²

89mm = 2.8kgs/m²

Key Application Qualifiers:

- Easily cut
- Better fit because the flexible edge compensates for normal frame variability
- Easier and faster to install
- Low moisture sorption
- Water resistant
- Non-combustible
- Fire resistant
- Excellent sound absorbency
- Chemically inert
- Does not rot or sustain vermin
- Does not promote growth of fungi or mildew
- CFC and HCFC free product and process
- Made from natural & recycled materials

Other ROXUL Products:

Please consult ROXUL for all your insulation needs. We have an extensive range of products for all applications from pipe insulation to commercial products to residential batts. ROXUL invites all inquiries and will act promptly to service all of your requirements.

Note:
As ROXUL Inc. has no control over installation design and workmanship, accessory materials or application conditions, ROXUL Inc. does not warranty the performance or results of any installation containing ROXUL Inc's. products. ROXUL Inc's. overall liability and the remedies available are limited by the general terms and conditions of sale. This warranty is in lieu of all other warranties and conditions expressed or implied, including the warranties of merchantability and fitness for a particular purpose.

ROXUL INC. 551 Harrop Drive, Milton, Ontario L9T 3H3 Tel: 905 878-8474 Fax: 905 878-8077
www.roxul.com Sales Office - Tel: 1-800-265-6878, Fax: 1-800-991-0110

Revised: June 1, 2002
Supercedes: February 28, 2001